

Bobbin work kit Operation Manual



BEFORE YOU START

Thank you for choosing our product. This manual describes the procedures for sewing bobbin work. For specific details on operating the machine, refer to the Operation Manual provided with your machine. The images and patterns used in this manual are for illustration purposes and may differ from the actual items. This is a kit used for sewing (utility stitches, decorative stitches or free-motion sewing). This kit cannot be used for machine embroidering.

CONTENTS

ABOUT BOBBIN WORK 2
INCLUDED ACCESSORIES 2
PREPARING FOR BOBBIN WORK 3
 Required Materials 3
 Upper Threading 4
 Preparing the Bobbin Thread 4
CREATING BOBBIN WORK 8
 Positioning the Fabric and Sewing 8
 Finishing the thread ends 10
 Bobbin Work Free-Motion Sewing 11
 Templates for Free-Motion Sewing 12
ADJUSTING THE THREAD TENSION 13
 Adjusting the Upper Thread Tension 13
 Adjusting the Tension of the Bobbin Thread 13
TROUBLESHOOTING 14

ABOUT BOBBIN WORK

You can create designs, which gives a three-dimensional appearance to the surface of the fabric, by winding the bobbin with heavy weight thread or ribbon too thick to be fed through the sewing machine needle and sewing on the wrong side of the fabric.

Bobbin work is sewn using the special bobbin case (gray) and bobbin cover with tabs included with this kit.

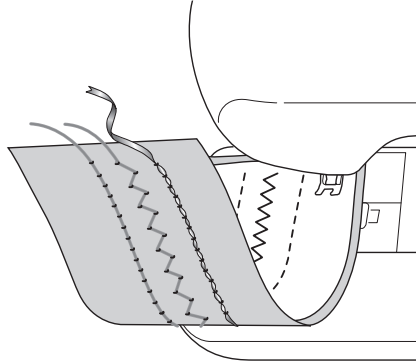

Utility stitches

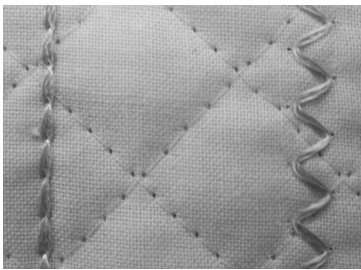

Decorative stitches
(For models with built-in decorative stitches)

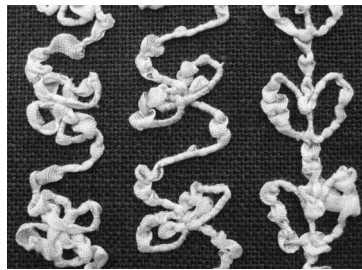

Free-motion sewing

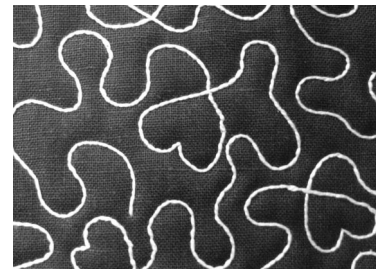

INCLUDED ACCESSORIES

1.

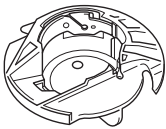

Bobbin case (gray)
(XE8298-001)

2.



Bobbin cover with tabs
(*See Note.)

3.



Screwdriver (small)
(X55468-051)

4.



CD-ROM (Contains the Operation Manual and the Templates for free-motion sewing.)
(USA/CANADA: XE9382-001,
Other areas: XE9501-001)



Note

- Two bobbin covers may be included, depending on the country or region where this kit was purchased. Use the bobbin cover with the same shape as the bobbin cover included with your machine. The bobbin cover with a shape different than that included with your machine cannot be installed on the machine.



(XE8992-001)



(XE8878-001)

PREPARING FOR BOBBIN WORK

Required Materials

■ Bobbin case and bobbin cover

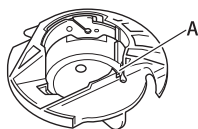

- ① Bobbin case (gray)
This bobbin case is only for bobbin work. The bobbin case will allow you to sew with thick thread or narrow ribbon that cannot be inserted through the eye of the needle. There is a notch at the location indicated by the letter "A".

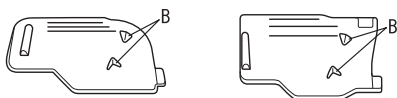

- ② Bobbin cover with tabs (for bobbin work)*
There are ribs "B" on the back of the bobbin cover. The ribs press down on the bobbin so it is not lifted out when thick thread is being fed from it. This bobbin cover can also be used with normal sewing.

* Two bobbin covers may be included, depending on the country or region where this kit was purchased. Use the bobbin cover with the same shape as the bobbin cover included with your machine. The bobbin cover with a shape different than that included with your machine cannot be installed on the machine.

■ Lower thread

We recommend the following types of threads for bobbin work.



No.5 or finer hand embroidery thread or decorative thread



Flexible woven ribbon (approx. 2mm (approx. 5/64 inch) recommended)



Fine embroidery ribbon (silk or silk-like material) (3.5 mm (approx. 1/8 inch) or less, recommended)

* If ribbon is to be used, we recommend that tension not be applied. Refer to page 6 for more detailed instructions.



Note

- Do not use thread heavier than No.5 hand embroidery thread.
- Some threads may not be appropriate for bobbin work. Be sure to sew trial stitches before sewing on your project.

■ Upper thread

Sewing machine embroidery thread (polyester thread) or monofilament (transparent nylon) thread.
If you do not wish for the upper thread to be visible, we recommend using transparent nylon monofilament thread or polyester light weight thread (50wt. or above) that is the same color as the lower thread.

■ Needle

Use a needle appropriate for the upper thread and fabric being used. For details, refer to your machine's Operation Manual.

■ Presser foot

Utility stitches or decorative stitches: Monogramming foot "N"



Note

- If monogramming foot "N" was not provided with your machine, use zigzag foot "J".
- When sewing a pattern described in the machine's Operation Manual and the monogramming foot "N" is recommended, be sure to use this foot, otherwise the desired results may not be achieved.

Free-motion sewing: Use the free-motion quilting foot provided with your machine. If you do not have a free-motion quilting foot, contact your nearest authorized dealer to purchase one.

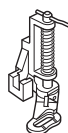

Free-motion quilting foot

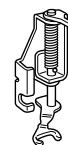

Free-motion open toe quilting foot "O"

■ Fabric

Be sure to sew trial stitches on a piece of scrap fabric, which includes the same threads and fabric as what is being used in your project.



Note

- The sewing results may be affected by the type of fabric used. Before sewing your project, be sure to sew trial stitches on a piece of scrap fabric that is the same as the fabric used in the project.

Upper Threading

1 Install a needle appropriate for the upper thread and fabric to be used.

For details on installing the needle, refer to the machine's Operation Manual.

2 Attach the presser foot.

For the presser foot to be used, refer to "Required Materials" on page 3.

For details on attaching the presser foot, refer to the machine's Operation Manual.

3 Thread the machine with the upper thread.

For details on threading the machine, refer to the machine's Operation Manual.

Preparing the Bobbin Thread

In order to create bobbin work, the bobbin case must be replaced with the one for bobbin work.

Before creating bobbin work, clean the bobbin case and the race.

1 Raise the needle and presser foot, and then turn off the machine.

2 Remove the flat bed attachment.

3 Remove the needle plate cover. For details on removing the needle plate cover, refer to the machine's Operation Manual.

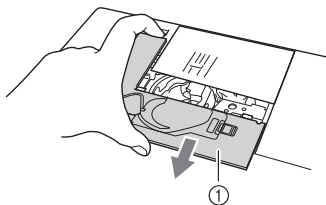

① Needle plate cover

4 Remove the bobbin case.

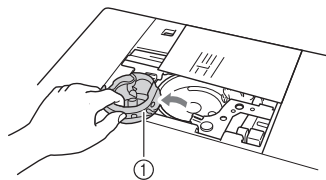

① Bobbin case

5 Use the cleaning brush included with the machine or a vacuum cleaner to remove any lint and dust from the race and its surrounding area.

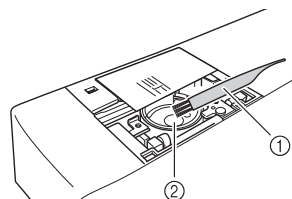

① Cleaning brush

② Race

6 Wipe the bobbin case (gray) with a soft lint free cloth to clean it.

7 Insert the bobbin case so that the projection on the bobbin case aligns with the spring. For details on inserting the bobbin case, refer to the machine's Operation Manual.

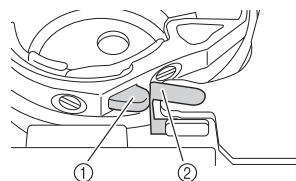

① Projection

② Spring



Note

- The bobbin case (gray) cannot be used for sewing in any way other than bobbin work. After sewing bobbin work, refer back to the steps in "Preparing the Bobbin Thread" for removing and cleaning the bobbin case (gray), and then reinstall the standard bobbin case (black).

⚠ CAUTION

- Be sure to use the bobbin case (gray) when creating bobbin work. Using any other bobbin case may result in the thread becoming tangled or damage to the machine.
- Make sure that the bobbin case is correctly installed. If the bobbin case is incorrectly installed, the thread may become tangled or the machine may be damaged.

- 8 Wind a decorative thread around the bobbin by hand. After winding the bobbin so it is filled as shown below (about 80%), cut the thread.



⚠ CAUTION

- Be sure to use the machine's included bobbin or one designed specifically for this machine. Using any other bobbin may result in damage or injuries.

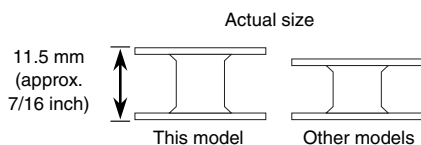

💡 Note

- Slowly and evenly wind the thread around the bobbin.
- For best results, wind the bobbin so the thread is snug and not twisted.

- 9 Using scissors carefully trim the thread tail as close to the bobbin as possible.

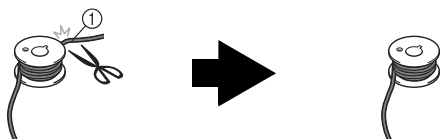

① Beginning of wound thread

⚠ CAUTION

- If thread extends beyond the top of the bobbin too much, the thread may become tangled or the needle may break.

- 10 Install the bobbin wound with thread.

Whether or not tension should be applied to the bobbin thread depends on the type of thread being used.

■ When tension is applied to the bobbin thread

Insert bobbin into bobbin case so the thread unwinds from the left side.

Then correctly pass the thread through the tension spring as shown below.

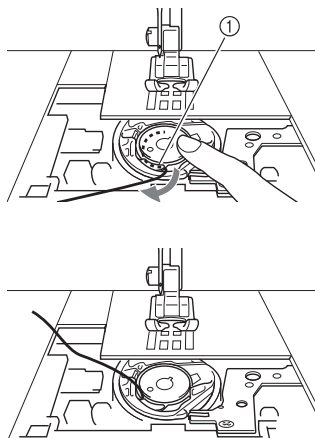

① Tension spring

⚠ CAUTION

- When winding the bobbin, make sure the thread is not frayed. Sewing with frayed thread may result in the thread catching on the tension spring of the bobbin case, the thread becoming tangled or damage to the machine.
- Do not guide the bobbin thread through the groove in the needle plate cover, otherwise the lower threading cannot be done correctly.

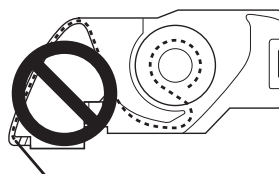

■ When tension is not applied to the bobbin thread

If the bobbin thread in the trial stitching is too tight and adjusting the bobbin case tension does not help (*As described in “Adjusting the Tension of the Bobbin Thread” on page 13), do not pass the thread through the tension spring.

Hold the bobbin with your left hand so the thread unwinds from the right side and hold the end of the thread with your right hand.

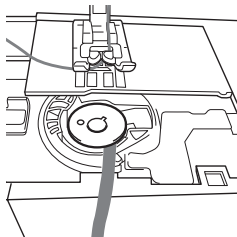
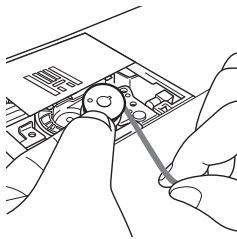

11 Pull out about 8 cm (approx. 3 inches) of bobbin thread.

12 Lightly hold the end of the upper thread while turning the handwheel toward you (counterclockwise) until the mark on the handwheel aligns with the center top of machine.

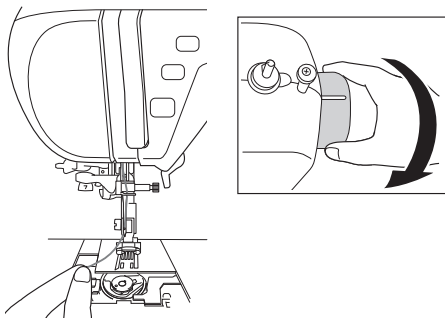

13 Gently pull the upper thread to bring the bobbin thread up through the needle plate.

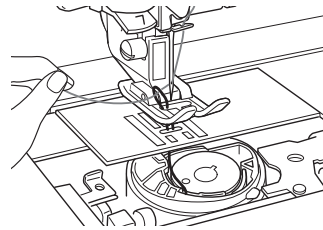

→ A loop of the bobbin thread comes out through the hole in the needle plate.

14 Insert tweezers through bobbin thread loop and pull bobbin thread above the needle plate.

15 Align the upper thread and bobbin thread, and then pull out about 10 cm (approx. 4 inches) of the threads and pass them under the presser foot toward the rear of the machine.

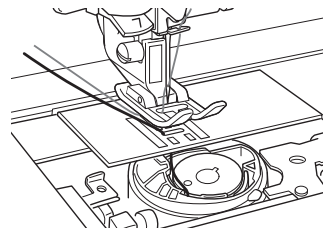

16 Install the needle plate cover and bobbin cover with tabs.

For details on installing the needle plate cover, refer to the machine's Operation Manual.

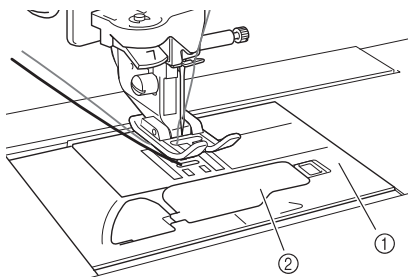

- ① Needle plate cover
- ② Bobbin cover with tabs

Note

- Two bobbin covers may be included, depending on the country or region where this kit was purchased. Use the bobbin cover with the same shape as the bobbin cover included with your machine. The bobbin cover with a shape different than that included with your machine cannot be installed on the machine.

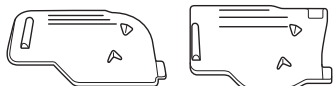

CAUTION

- When creating bobbin work, use the bobbin cover with tabs, otherwise the thread may become tangled or the needle may break.

Note

- When installing the needle plate cover, do not allow it to pinch the thread.

17 Install the flat bed attachment.

Note

- When installing the flat bed attachment, do not allow it to pinch the thread.
- When the bobbin thread is replaced with a new one, be sure to repeat the procedure from ① on "Preparing the Bobbin Thread", otherwise the lower threading will not be done correctly.

→ This completes the upper and lower threading.

CREATING BOBBIN WORK

Positioning the Fabric and Sewing

Note

- Be sure to sew trial stitches using same fabric and threads as your project in order to check the sewing results.
- The bobbin thread may become tangled due to the type of pattern and thread that are being used. Since this may cause the needle to break, immediately stop sewing if this occurs. Turn off the machine and cut out the tangled thread with scissors. Then, clean the race and bobbin case as described in "Preparing the Bobbin Thread" on page 4.

- 1 Place a lightweight tear-away stabilizer on top (wrong side) of the fabric.
- 2 Using an awl, punch a hole in the fabric at the beginning of stitching so the bobbin thread can be fed through the fabric.

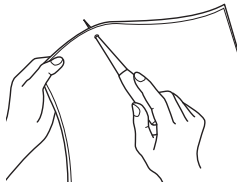

- 3 Use the presser foot lever to raise the presser foot.
- 4 With the wrong side facing up, place the fabric with stabilizer under the presser foot.

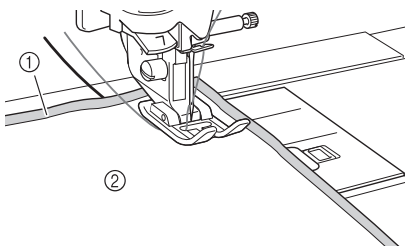

- 1 Wrong side of fabric
- 2 Stabilizer on wrong side of fabric

- 5 Turn the handwheel toward you (counterclockwise) to feed the needle into the punched hole. Position the upper thread over the presser foot and lightly hold then, lower the presser foot.

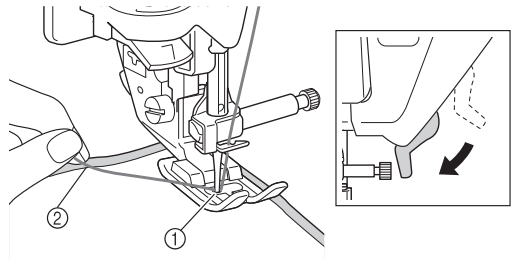

- 1 Punched hole
- 2 Upper thread over the presser foot

- 6 Pulling the upper thread gently, turn the handwheel toward you (counterclockwise) until the mark on the handwheel aligns with the center top of machine.

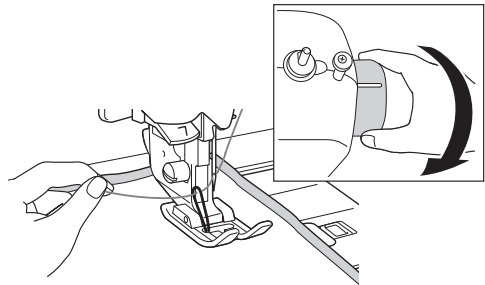

→ A loop of the bobbin thread comes up through the hole in the fabric.

- 7 Raise the presser foot lever, and then use tweezers to pull up the bobbin thread and bring the end of the thread to the top of the fabric.

Note

- Pull the thread while holding down the fabric so it does not move out of place.

- 8 Align the upper thread and bobbin thread, and then pass them under the presser foot toward the rear of the machine.

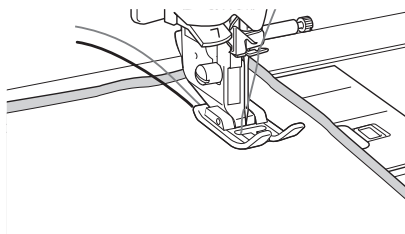

- 9 Turn on the machine.

- 10 Select a stitch.



Memo

- For best results, select a longer stitch length and a wider stitch width. Depending on the selected stitch, it may not be possible to change the stitch length and stitch width settings. For details on adjusting the stitch length and stitch width, refer to the machine's Operation Manual.
- Depending on the fabric, bunched stitches may result. We recommend selecting a simple stitch and sewing trial stitches to check the sewing results.

Examples of simple stitches: 

- 11 Adjust the upper thread tension.

For details on adjusting the upper thread tension, refer to the machine's Operation Manual.



Memo

We recommend an upper thread tension that is higher than the standard setting.

- 12 If your machine is equipped with the automatic thread cutting function and automatic reinforcement/reverse stitching function, make sure the automatic thread cutting and automatic reinforcement/reverse stitching have been turned off.

CAUTION

- Before sewing, make sure the automatic thread cutting has been turned off. If sewing is started with automatic thread cutting turned on, the thread may become tangled or the machine may be damaged.

- 13 While gently holding threads at the rear of the machine, turn the handwheel to feed the needle into the punched hole again, and then lower the presser foot lever.

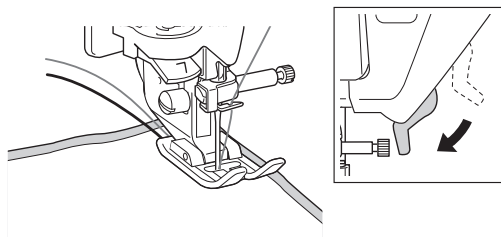
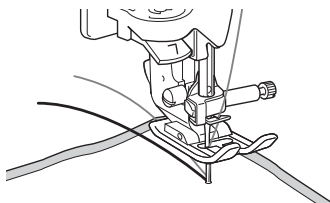

- 14 Select a low speed, gently hold the threads behind the presser foot and start sewing. Threads can be released after several stitches have been made.



Note

- Before sewing, check that there is enough thread in the bobbin.

- 15 When you have reached the end of the stitching area, stop the machine.



Note

- Do not sew reinforcement/reverse stitches at the end of the stitching, otherwise the threads may become tangled or the needle may break. In addition, it will be difficult to pull the bobbin thread up to the wrong side of the fabric.

- 16 Raise the needle and presser foot.

- 17** Leaving about 10 cm (approx. 4 inches) of thread at the ends, use scissors to cut the threads.

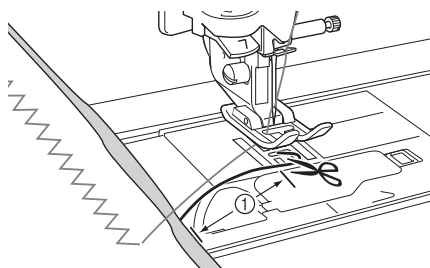

① 10 cm (approx. 4 inches)

Note

- Do not sew reinforcement/reverse stitches or use a “Thread Cutter” button (if so equipped) at the end of the stitching; otherwise it will be difficult to pull the bobbin thread up to the wrong side of the fabric. In addition the threads may become tangled or the needle may break possibly causing machine damage.

Finishing the thread ends

- 1** At the end of the stitching, pull the end of the bobbin thread up to the wrong side of the fabric.

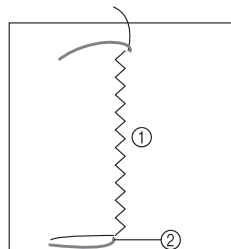

- ① Wrong side of fabric
② Bobbin thread

Note

- If it is difficult to pull up the bobbin thread, use a ribbon embroidery needle to pull the thread up to the wrong side of the fabric. Otherwise, use an awl to pull up the bobbin thread.

- 2** From the wrong side of the fabric, tie the bobbin thread and the upper thread together by hand, and then cut off excess threads with scissors.

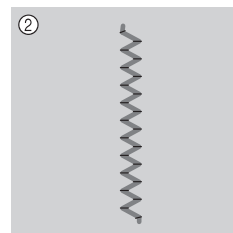
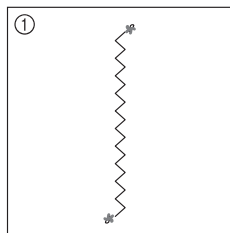

- ① Wrong side of fabric
② Surface of fabric

Note

- To ensure threads do not come undone after being tied place a drop of fabric glue on knots.

- 3** If the desired results could not be achieved, adjust the tension of the bobbin thread and of the upper thread, and then try sewing the stitching again.

For more details, refer to “ADJUSTING THE THREAD TENSION” on page 13.

Bobbin Work Free-Motion Sewing



Note

- For bobbin work free motion sewing use the instructions for “CREATING BOBBIN WORK” beginning on page 8.
- Use the quilting foot provided with your machine. If you do not have a quilting foot, contact your nearest authorized dealer to purchase. For details on using the quilting foot, refer to the Operation Manual provided with your machine or with the presser foot.

If so desired, use a template or draw your design on the stabilizer to allow for ease of stitching. Remember, your stitches with your decorative thread will be on the underneath side of your fabric and the stabilizer will be on the top of the wrong side of your fabric.

The CD-ROM included with this kit contains template data for free-motion sewing. For a list of the template designs, refer to “Templates for Free-Motion Sewing” on page 12.

1 Print the desired template.



Note

- Print the template in its original dimensions. If an enlarged template is used, the bobbin thread may run out during sewing.

2 Affix the stabilizer to the wrong side of the fabric.

3 Place commercially available transfer paper on the stabilizer, then the paper printed with the template on top, and then trace the design with a pencil.

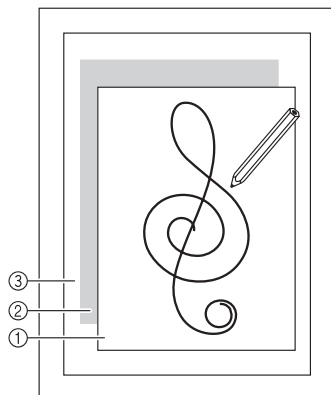

- ① Template
- ② Transfer paper
- ③ Stabilizer on wrong side of fabric

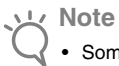

Note

- Some templates have the arrows to show you the sewing direction. Trace the arrows with design.

4

Once the design is transferred to the stabilizer, position the fabric under the free-motion presser foot on the machine, and then use free-motion sewing to sew the design.

Templates for Free-Motion Sewing



Note

- Bobbin work is sewn with the wrong side of the fabric facing up. For this reason, the template designs are backwards.

- ① Wrong side of fabric (template design)
- ② Right side of fabric

No.1
No.01.pdf



No.2
No.02.pdf

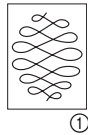

No.3
No.03.pdf

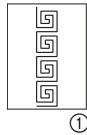

No.4
No.04.pdf

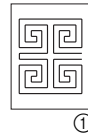

No.5
No.05.pdf



No.6
No.06.pdf



No.7
No.07.pdf



No.8
No.08.pdf

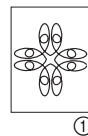

No.9
No.09.pdf



No.10
No.10.pdf

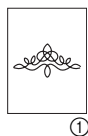

No.11
No.11.pdf

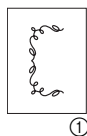

No.12
No.12.pdf



No.13
No.13.pdf



No.14
No.14.pdf



No.15
No.15.pdf



No.16
No.16.pdf

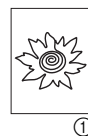

No.17
No.17.pdf



No.18*
No.18.pdf



No.19*
No.19.pdf



No.20
No.20.pdf



* These templates have the arrows to show you the sewing direction. Trace the arrows with design when transferring the design to the stabilizer.

ADJUSTING THE THREAD TENSION

After sewing trial stitches and checking the sewing results, adjust the thread tensions if necessary. After adjusting the tensions, be sure to sew trial stitches again in order to check the sewing results.

Adjusting the Upper Thread Tension

We recommend an upper thread tension that is higher than the standard setting.

Refer to the machine's Operation Manual for detailed instruction.

Adjusting the Tension of the Bobbin Thread

If the desired stitching cannot be achieved after adjusting the upper thread tension, adjust the tension of the bobbin thread. The tension of the bobbin thread can be adjusted by turning the slotted-head (-) screw on the bobbin case (gray) for bobbin work.

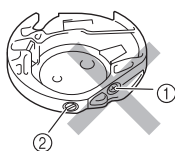

- ① Do not turn the phillips screw (+).
- ② Adjust with the small screwdriver.

To increase the tension of the bobbin thread, turn the slotted-head (-) screw 30° to 45° clockwise.

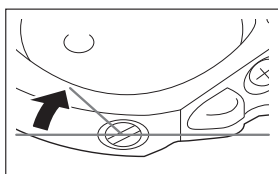

To decrease the tension of the bobbin thread, turn the slotted-head (-) screw 30° to 45° counterclockwise.

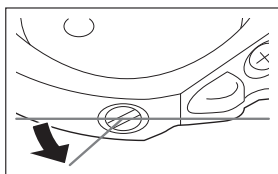

Note

- Turning the screw on the bobbin case (gray) may push up the spring plate, as shown below. If this occurs, gently press down the spring plate with a screwdriver so it is lower than the top surface of the bobbin case (gray), and then insert the bobbin case into the machine.

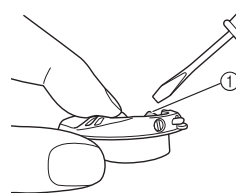

① Spring plate

CAUTION

- **DO NOT** adjust the position of the phillips (+) screw on the bobbin case (gray) as this may result in damage to the bobbin case, rendering it useless.
- If the slotted screw (-) is difficult to turn, do not use force. Turning the screw too much or providing force in either (rotational) direction may cause damage to the bobbin case. Should damage occur, the bobbin case may not maintain proper tension.

Note

- If the bobbin thread tension is tight, the thread cannot be passed through the tension spring when the bobbin is installed in the bobbin case. (Refer to "When tension is not applied to the bobbin thread" on page 6.)

TROUBLESHOOTING

Several solutions for minor problems are described below. If the problem persists, contact your nearest authorized dealer.

- The thread was accidentally cut automatically and the bobbin thread is caught inside the machine (Only for machines equipped with the automatic thread cutting function)

- 1 Cut the thread near the fabric above the needle plate, and then remove the fabric.

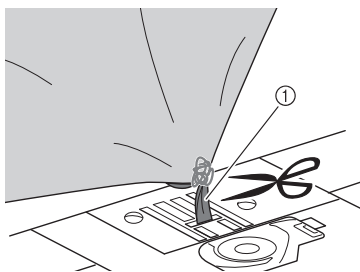

① Thread

- 2 Remove the bobbin, and then hold it out toward the left side of the machine.

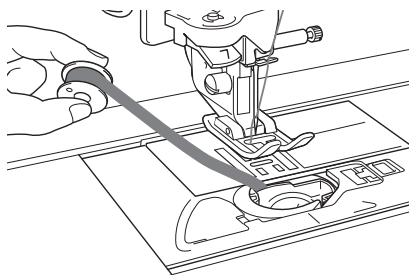

- 3 Lower the presser foot.

- 4 Press the "Thread Cutter" button again, and then pull the thread out to the left while the thread cutter is operating.

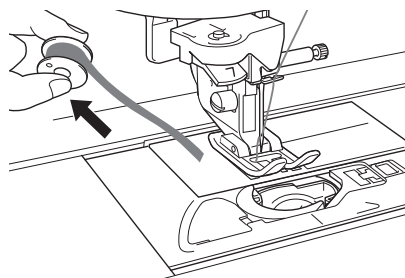

CAUTION

- Do not pull on the thread with excessive force, otherwise the machine may be damaged.

- The pattern is misaligned

Refer to "ADJUSTING THE THREAD TENSION" and increase the upper thread tension. If the pattern is still misaligned, reduce the tension of the bobbin thread.

Example: Decorative Stitch

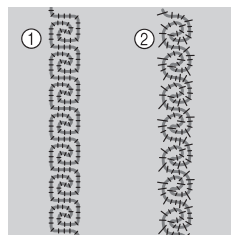

- ① Correct tension
- ② The upper thread tension is too loose, or the bobbin thread tension is too tight.

- The bobbin thread catches on the tension spring of the bobbin case

Sew with no tension applied to the bobbin thread. (Refer to "When tension is not applied to the bobbin thread" on page 6.)

